

## Quick Start Guide



720P HD Wide Angle Rotatable  
WiFi Portable Camera



### Structures

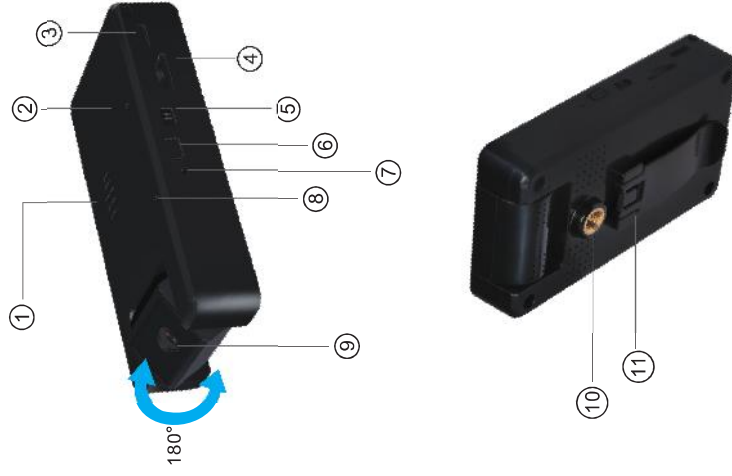

### ① Speaker

### ② Microphone

### ③ USB power supply port(No Data Transfer Function)

### ④ Micro SD card slot(Up To 64GB Micro SD Card)

### ⑤ Power On/Off

### ⑥ Recording Key: Stop/Start video recording

### ⑦ Reset : To reset the device, insert a pin into the reset hole and hold for 10 sec

### ⑧ Indicator:

Blue LED solid: in Wi-Fi network of the router. Blue and Red LED flashing at the same time: In AP mode. Red LED solid: Wi-Fi setup successful and the device will auto reboot

### ⑨ Camera: 128 degree wide angle, it can be rotated horizontal 180 degree manually

### ⑩ Bracket socket: Can be worked with other sport bracket

### ⑪ Pocket clip

# **BSTCAMPRO**

## Quick Start Guide



Be Home without being Home!

Force Protection Video  
855.746.0245

# 1.Install the App “BSTCAMPRO”

We provide 2 options to install **BSTCAMPRO** app  
( 1) Scan the QR code on this page with QR code reader on your smartphone. the app will be downloaded automatically.



Apple store: “BSTCAMPRO”



Google play: “BSTCAMPRO”

( 2) To manually install BSTCAMPRO, simply go to Apple Store(iOS) or Google Play Store(Android) on your phone, Search and download the app “ **BSTCAMPRO**” Once “**BSTCAMPRO**” icon shows on your phone, the app is successfully installed

## 2-A. Configure Device with Internet Wi-Fi (iPhone)

- (1) Go to **Settings** >> **Wi-Fi** on your smart phone, and turn on Wi-Fi function
- (2) Enable the Wi-Fi to search and join the name of internet Wi-Fi network which you need to connect with the device
- (3) Return to home screen and start the app "**BSTCAMPRO**"
- (4) To add device to **Device List**, go to **Device List** on the app, press the **+** on the upper right corner of the screen, next, select **Configure camera** to proceed

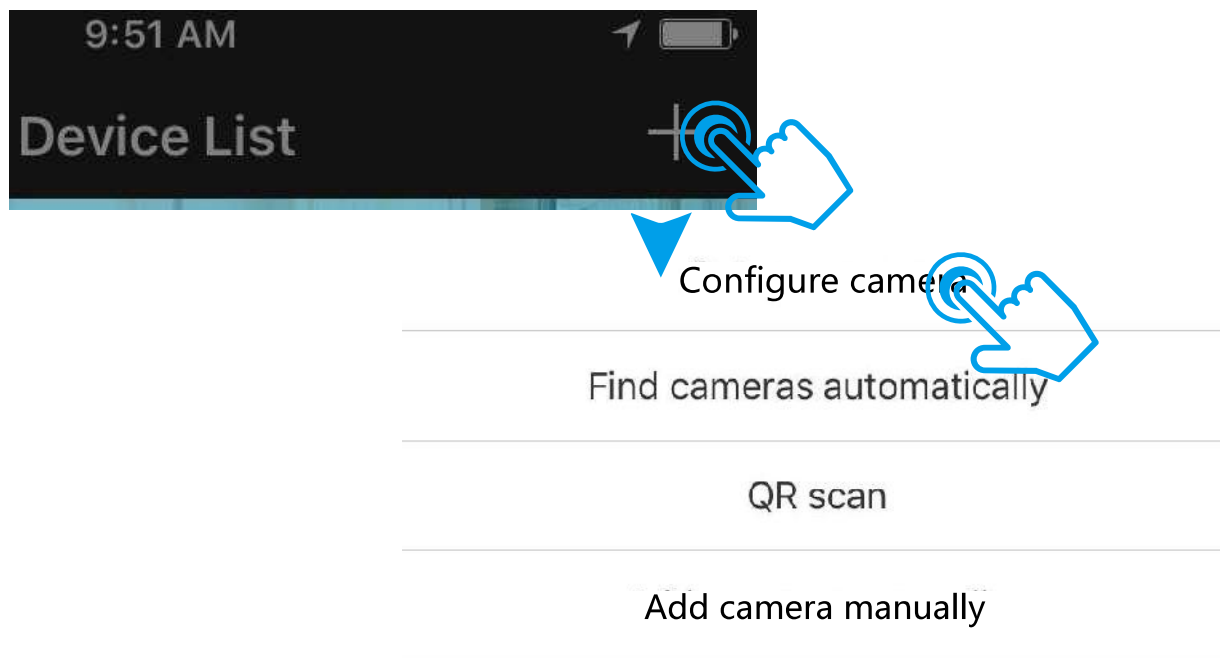

- (5) Enter the **SSID** and **Password** of your internet Wi-Fi, and press **Next** (Note: Specific symbols and punctuations are not allowed. and only support 2.4GHz internet Wi-Fi network.)
- (6) Return to home screen and go to **Settings** >> **Wi-Fi** on your smart phone, search and join the network of Camera ID on the device. ( For example ET890815003), enter the password "**88888888**". Then the Camera ID will be selected in few seconds

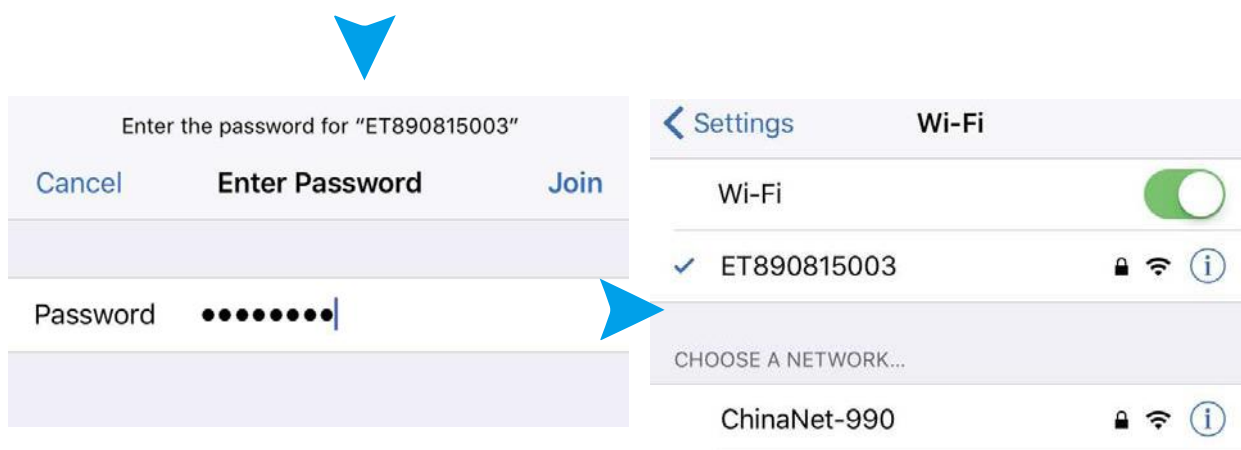
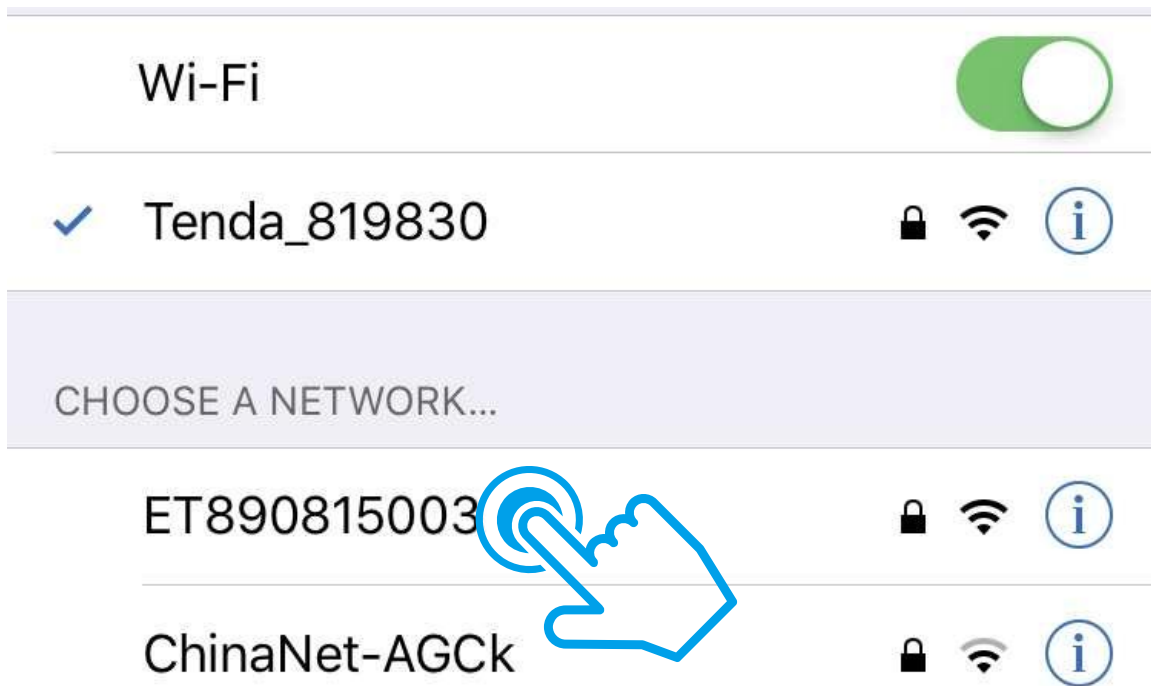

- (7) Return to the app "BSTCAMPRO" , and press **Next** to wait for camera connecting with internet Wi-Fi.
- (8) Verify access code and press **Next** to add device to **Device List**

## 2-B. Configure Device with Internet Wi-Fi (Android)

- (1) Go to **Settings** >> **Wi-Fi** on your smart phone, and turn on Wi-Fi function

- (2) Enable the Wi-Fi to search and join the name of internet Wi-Fi network which you need to connect with the device
- (3) Return to home screen and start the app "**BSTCAMPRO**"
- (4) To add device to **Device List**, go to **Device List** on the app, press the **+** on the upper right corner of the screen, Next, select **Configure camera** to proceed

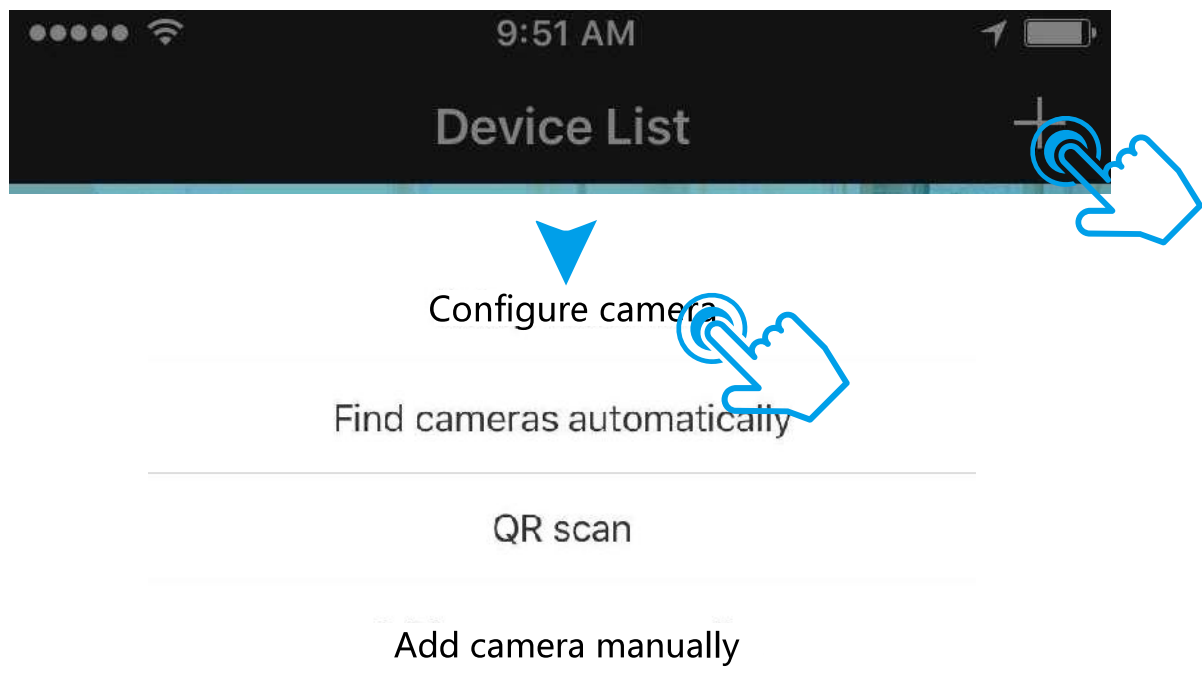

- (5) Enter the **SSID** and **Password** of your internet Wi-Fi and press **Next**(**Note: Specific symbols and punctuations are not allowed. and only support 2.4GHz internet Wi-Fi network.**)
- (6) If one single camera is found, just waiting for camera connecting with internet Wi-Fi. If more than one single cameras are found, please select which camera ID you need to configure and enter password: **88888888**. then tap on **Next** to wait for camera connecting with internet Wi-Fi.
- (7) Verify access code and press **Next** to add device to **Device List**

### 3. Configure Device with P2P Wi-Fi

- (1) Start the app "**BSTCAMPRO**"
- (2) To add device to **Device List**, go to App, press the **+** icon on the upper right corner of the screen, next select method A or B to save camera to your **Device List**

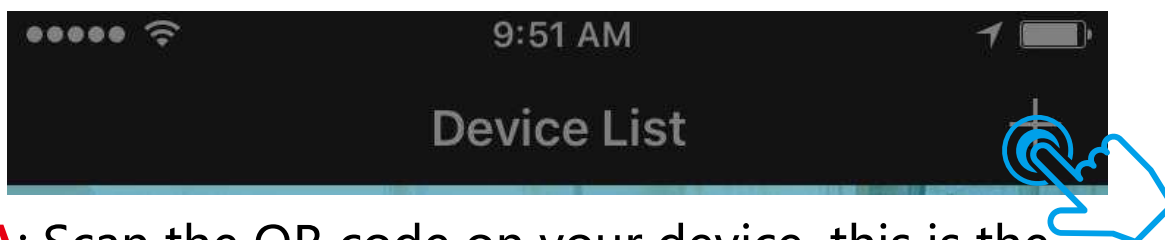



**A:** Scan the QR code on your device, this is the quickest way to add the camera

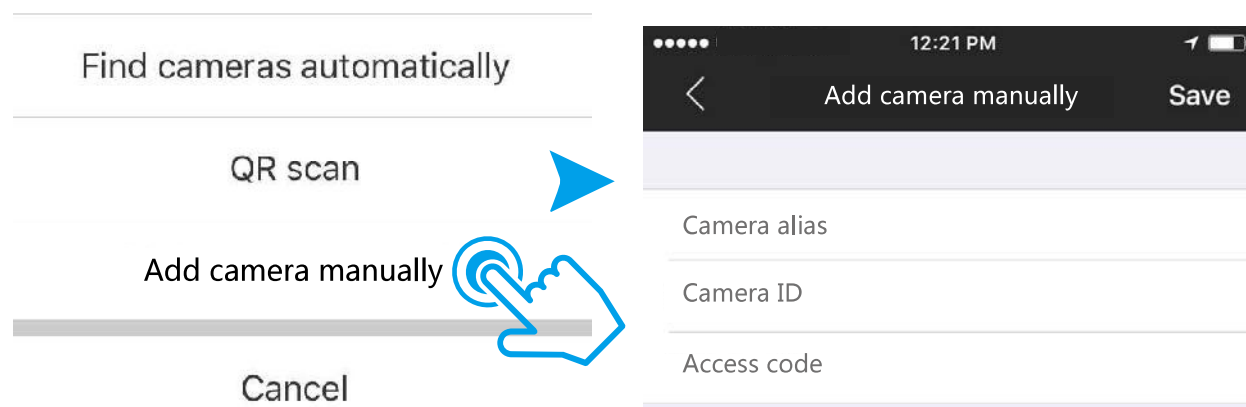

Put the QR code of the device in the rectangular box

**B:** Press **Add camera manually**, and manually enter the camera ID and code which are displayed on the device





- (3) Go to **Settings** >> **Wi-Fi** on your smart phone, search and join the network of Camera ID on the device.( For example ET890815003), enter the password "**88888888**" .the Camera ID will be checked in few seconds
- (4) Return to the app "**BSTCAMPRO**" ,when the play icon  appears on live view screen, it means the Device Wi-Fi(P2P connection) is successfully figured.Tap on Play icon to watch live view.

## 4. Stream Live View



With the internet Wi-Fi(IP connection) successfully connected, you can start to remotely control your camera.

- (1) Go to **Device List** and tap on Play icon  on the device you want to operate, then a live view will be displayed on the screen.
- (2) Press **Record** to start video recording, press Record again to stop record, it shows popup "**Recorded successfully**"
- (3) To take a snap shot, tap on **Capture**, and shows popup "**Captured successfully**"
- (4) Go to **Device List** >> **Albums** to check all your videos and photos

## 5. Pan & Tilt & Auto Patrol(For PT models only!)





- (1) Go to **Device List** and tap on Play icon  on the device you want to operate, then a live view will be displayed on the screen.
- (2) Press pan left icon  to start pan left, press it again to stop
- (3) Press pan right icon  to start pan right, press it again to stop



- (4) Press tilt up icon  to start tilt up, press it again to stop
- (5) Press tilt down icon  to start tilt down, press it again to stop
- (6) Press auto patrol icon  to start auto patrol, press it again to stop



## 6. Playback & Download & Share Videos and Photos

- (1) To playback videos on your phone, go to **Device List** and tap on **Playback** icon  for the device you need to playback, enter to playback menu and select the video file you want to play.
- (2) To back up files to your phone, tap **Snapshot** icon  or **Record** icon  to start backup file during playback. Then go to **Device List >> Albums** to check all your backup videos and photos.
- (3) To share files with your friends & families, Go to **Device List >> Albums**, press **Edit** on the upper right corner, and select videos & photos you need to share with, tap on **share** icon  to proceed.

## 7. Change Record Modes(Stop, Automatic, Motion Detection, Schedule)

- (1) To change different record modes, go to **Device List** and tap on the gear icon  of the device you want. Then select **Recording setting** to proceed different record modes and tap on **Save** on the upper right corner
- (2) To add schedule record, go to **Recording setting** to select **Schedule**, and tap on **Schedule record setting** to add schedule record time, here we offer three schedule record time periods, and select Start time and Stop time, press **Confirm**, then press **Save** on the upper right corner, next tap on **Save** on the upper right corner of **Recording setting**. And press **Confirm**

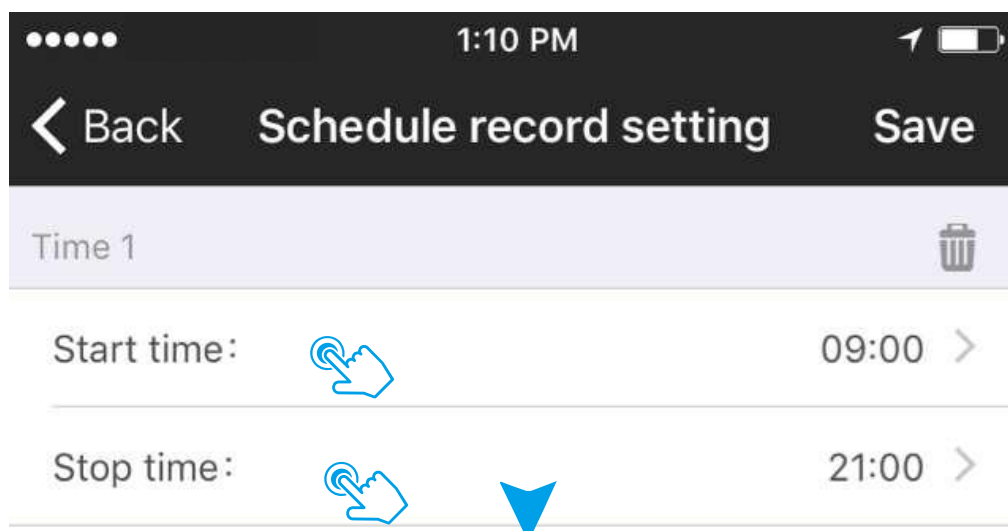
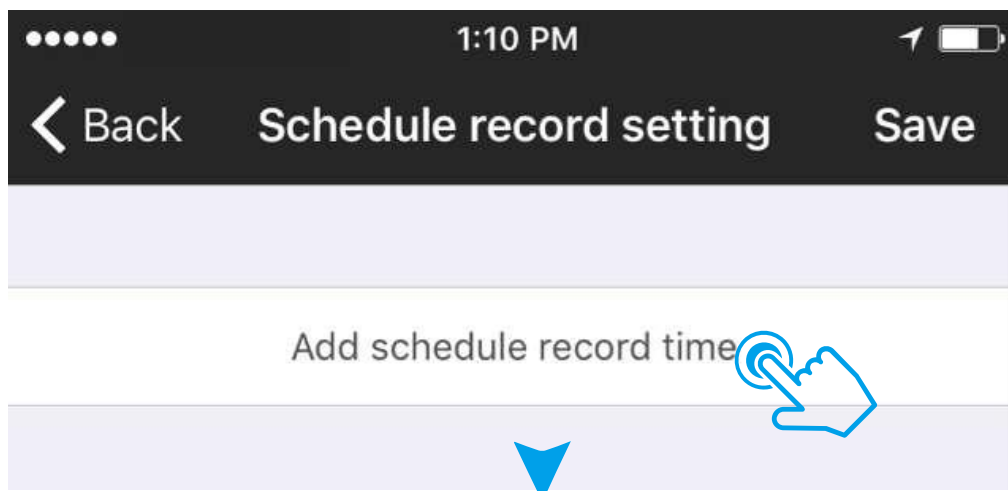

9	57	
10	58	AM
<b>11</b>	<b>59</b>	<b>PM</b>
12	00	
1	01	
Cancel		Confirm

1:14 PM

< ET890815003 Record setting Save

Record mode Schedule >

Record with audio

Video duration (Min.) 5



Schedule record setting 00:00~23:59 09:00~21:00... >

**Configured successfully!**

Total 7600

Used 6772

Confirm

- (3) To delete schedule record, go to **Recording setting** to select which schedule recording setting you want to delete, and press delete icon  to proceed, and tap on **Save** on the upper right corner, next press **Save** on the upper right corner of **Recording setting**.
- (4) To change motion detection sensitivity, go to **Device List >> Gear icon  >> Alarm Setting**, and tap on **Motion sensitivity**, then select sensitivity level you need, tap on **Save**.

## 8. Change Internet Wi-Fi (IP connection) setting

- (1) Make sure your phone and device are connected to the same Wi-Fi Internet. (For example, here they are both connected to Tenda\_819830)

Wi-Fi Setting on phone

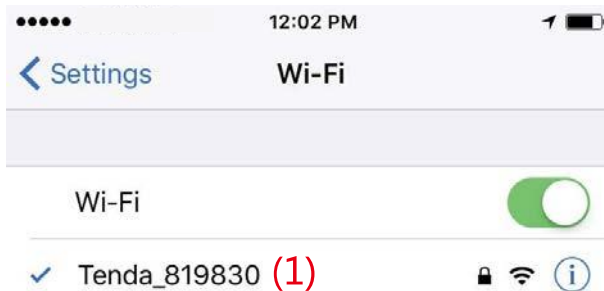

Wi-Fi setting on device

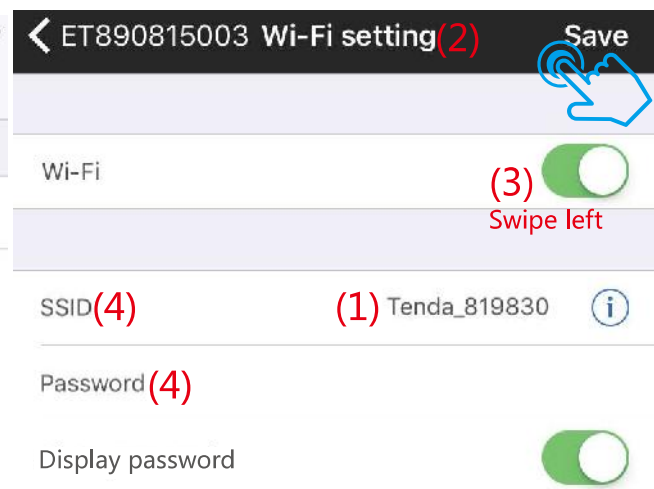

- (2) Go to **Device List >> Gear icon  >> Wi-Fi setting**
- (3) If you want to turn off the Internet Wi-Fi (IP connection) on device, please swipe it to the left. Device will automatically restore to P2P connection.
- (4) If you want to change to another internet Wi-Fi access, enter the new SSID & new password, and press **Save**

## Note:

- (1) If you fail to complete Internet Wi-Fi changes, please default device and start over the guide of [Configure Device with Internet Wi-Fi](#)
- (2) If the information "Work at Local Area Network only!" pops up, please make sure the device and phone booth are connected to the same Wi-Fi internet.
- (3) Wi-Fi SSID and Password with specific symbols and punctuations are not allowed

## 9. Change Access Code

- (1) Go to [Device List](#), Tap on the gear icon  of the device you want, Then select [Change access code](#).
- (2) Enter the information asked (Old code/New code/Re-enter new code), and then tap on [Save](#)

## 10. Turn on Motion Detection Notification

- (1) Go to [Device List >> Gear icon !\[\]\(8c4dca64662d21542001ca0ed7eeb688\_img.jpg\) >> Alarm setting](#), and swipe right to turn on
- (2) Select motion sensitivity level and tap on [Save](#)
- (3) Go to [Device list >> Events](#) to check all the motion detection notification

## 11. Turn off Push Notification

Android: Go to [Device List >> More >> Push](#), then swipe left to deactivate notification

iOS: Go to [Main setting](#) (on your phone) [>> Access Notification >> Access BSTCAMPRO >> Deactivate Notification](#)

## 12. Questions & Answers

**Question:** Why the PT and start/stop auto patrol are not worked for my device?

**Answer:** Please make sure your device does come with PT features

---

**Question:** Why the message “Work at Local Area Network only” pops up when I want to change some setting?

**Answer:** Please be kindly noted that the device and your phone both are connected to the same internet Wi-Fi

**Question:** Can I select stop record or overwrite when micro SD is full on my device?

**Answer:** It can't be selected. We default all our device with overwrite function when SD is full.

**Question:** How do I default access code on my device?

**Answer:** We provide two ways to reset camera access code, make sure you had the device been configured Internet Wi-Fi, then the device and your phone both are connected to the same internet Wi-Fi network

**A:** Go to **Device List >> Gear icon  >> System setting**, tap on **Factory reset**

**B:** Hold Reset button on the device up to 10 seconds with reset pin(Included with accessories)

**Question:** How do I update my camera with latest firmware?

**Answer:** Go to **Device List >> Gear icon  >> System setting**, tap on **Firmware update** to proceed

**Note:**

- (1) Make sure your device and phone both are connected to the same internet Wi-Fi network
- (2) If the firmware version is still keep the same as old one, please restart your device after firmware updated

**Question:** How do I change my camera name as my demand?

**Answer:** Go to **Device List >> Gear icon  , tap on Device alias** to change camera name

---

**Question:** How do I change recording time of automatic video record?

**Answer:** Go to **Device List >> Gear icon**  **>> Record setting**, Tap on **Video duration**(Min.) and enter recording time you need

**Note:** Recording time should be configured between 3 minutes and 30 minutes.

**Question:** Why the P2P or IP is configured, but the devices still show Offline in Device List?

**Answer:** Please try to swipe down the Device List to refresh

**Question:** Why I received popup "Fail to get data information" ?

**Answer:** Please go back to **Device List** swiping down to refresh device list and enter into setting to configure again

**Question:** Why I can only see the spinning wheel when clicking Play icon to watch live view?

**Answer:** Please back to **Device List** and swipe down to refresh, then tap on Play icon  again.

**Question:** How do I add all my local network cameras to Device List?

**Answer:** Make sure your device and phone are connected to the same Wi-Fi network. then please go to **Device List >> Add Device +** , and tap on **Find cameras automatically** to check all cameras and add to your Device List

**Question:** How long it will record when motion detection is triggered?

**Answer:** It will stop record within 3 minutes when there is no more motion triggered